



COLORADO STATE UNIVERSITY-PUEBLO

FIRE SAFETY AND SECURITY REPORT

ISSUED ANNUALLY IN COMPLIANCE WITH THE JEANNE CLERY ACT 20 USC 1092(F)
AND HIGHER EDUCATION OPPORTUNITY ACT

2011



Questions or Concerns?
Environmental Health and Safety
(719) 549-2747
Pueblo County Sheriff at CSU-Pueblo
(719) 549-2373

Table of Contents

President’s Letter	2
Campus Emergency Call Box Map.....	3
Background and Introduction	4
Preparing the Annual Report	4
Law Enforcement Qualifications and Authority.....	4
Reporting A Crime.....	5
Confidential Reporting.....	5
Reporting to a Campus Security Authority (CSA).....	5
Who is Exempt from Reporting Under the <i>Clery Act</i>	5
Security & Access to Campus Facilities	6
Security & Access to Campus Residential Facilities	6
Security Considerations in Maintenance of Campus Facilities	6
Crime Prevention	6
Sexual Assault and Sexual Harassment.....	7
Sex Offender Registry	10
Alcohol and Drug Policy	10
Missing Student Policy	11
Environmental Health and Safety Program	13
Fire Safety Policies	13
Plans for Future Improvements	14
Fire Statistics.....	15
Fire Suppression and Detection Systems.....	15
Emergency Preparedness	17
Timely Warnings	17
Emergency Notification System	17
Colorado State University – Pueblo Crime Statistics	19
Crime Statistics Table CSU-Pueblo	20

PRESIDENT'S LETTER



2200 BONFORTE BOULEVARD
OFFICE OF THE PRESIDENT

PUEBLO, COLORADO 81001-4901
719-549-2308
FAX: 719-549-2650

Your safety on our campus is among our highest priorities as a University, and Colorado State University—Pueblo has an excellent reputation as a safe, caring and low-crime campus. Our faculty, staff and students are a community that recognizes the importance of looking out for one another and helping provide a safe and secure environment where we successfully live, study, work, and enjoy all the benefits of a vibrant academic community.

Preserving this welcoming, peaceful environment begins with providing open access to information about campus crime incidents, reporting, and resources. This report helps spotlight safety issues and statistics on our campus and provides the most current information about ways to help keep you and your environment secure and free from harm. Our University takes a strategic, integrated approach to campus safety planning, and has a strong partnership with the Pueblo County Sheriff to ensure we are well-coordinated, trained, and prepared in the event of an emergency, crime, or natural disaster. This safety leadership team works to ensure all aspects of campus safety are addressed in our planning and to regularly assess campus safety concerns.

Still, your own common sense, careful planning, and understanding of available resources are the best tools to help you avoid becoming the victim of a crime, whether you are on our campus or in the greater community. Prepare yourself by learning more about the University's campus safety programs – along with our rules and expectations. We encourage students and parents both to read and understand the information provided about substance abuse, alcohol poisoning, and student obligations to friends and peers.

Read this report, ask questions, and make your safety at Colorado State University—Pueblo a personal priority.

Sincerely,

A handwritten signature in black ink, appearing to read "Julio S. Leon".

Julio S. Leon
Interim President

CAMPUS EMERGENCY CALL BOX MAP

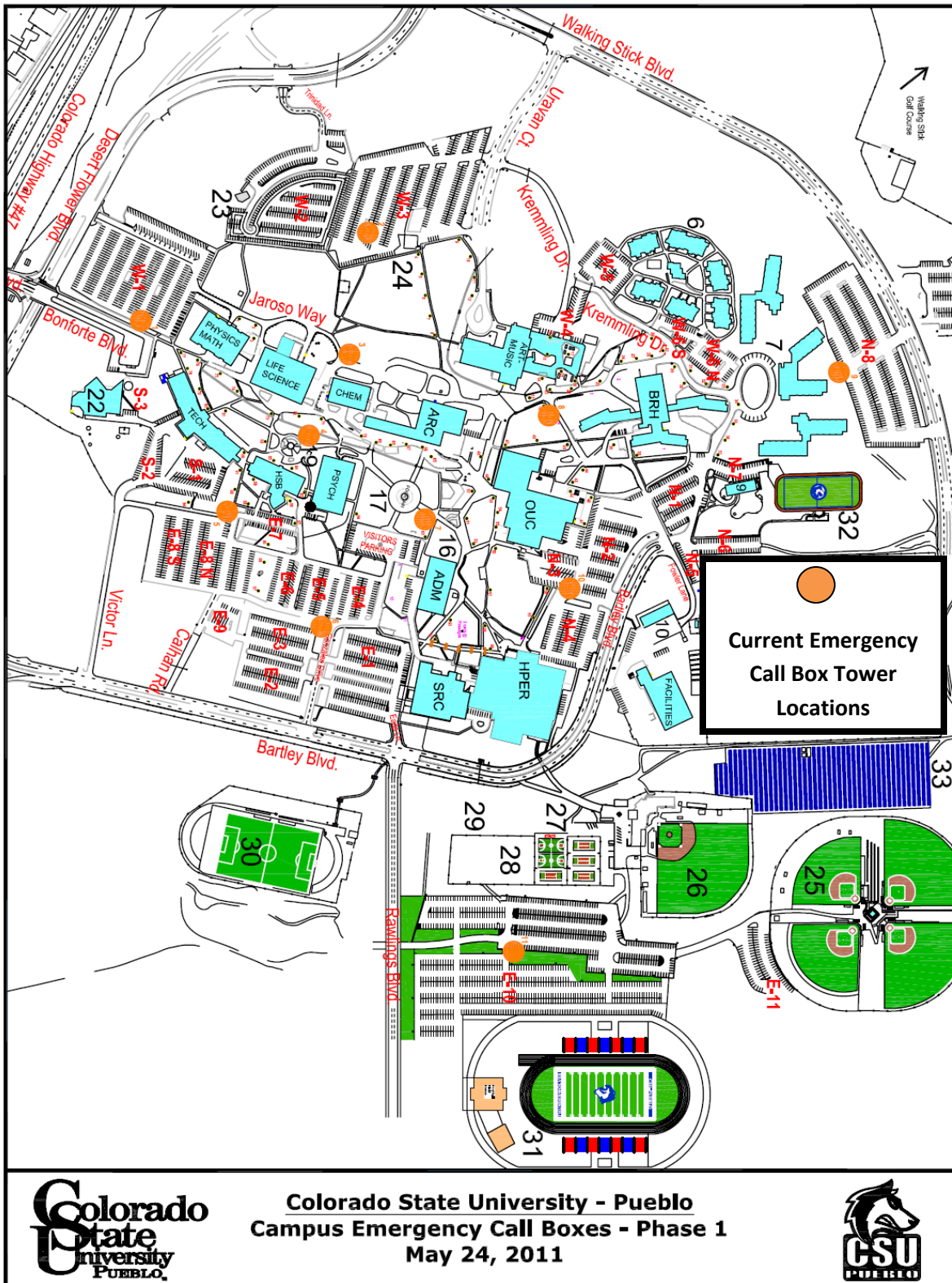

BACKGROUND AND INTRODUCTION

The information provided in this report is meant to educate current students, prospective students, faculty and staff about safety and security policies, procedures, and statistics for Colorado State University – Pueblo (the “University” or “CSU-Pueblo”). The University firmly believes that a well-informed campus community is better prepared to deal with crime and emergency situations. The University encourages campus community members to become actively involved with the safety and security of students, faculty, and staff.

In 1990, the Higher Education Act of 1965 (HEA) was amended to include the Crime Awareness and Campus Security Act of 1990 (Title II of Public Law 101- 542). This amendment required all postsecondary institutions participating in Title IV student financial aid programs to disclose campus crime statistics and security information. In 1998, the act was renamed the Jeanne Clery Disclosure of Campus Security Policy and Crime Statistics Act in memory of Jeanne Clery, a university student who was killed in her dorm room in 1986. More commonly known as the *Clery Act*, this law requires colleges and universities to

- • Collect, classify and count crime reports and statistics
- • Issue campus alerts
- • Publish an annual security report
- • Submit crime statistics to the Department of Education
- • Maintain a daily crime log
- • Disclose missing student notification procedures
- • Provide fire safety information

PREPARING THE ANNUAL REPORT

This report is compiled by the Director of Environmental Health and Safety in collaboration with the

- CSU-Pueblo County Sheriff’s Office
- Dean of Student Affairs, Associate
- Dean of Student Affairs/Sexual Assault Response Coordinator
- Associate Vice President of Facilities Management
- Director of Student Judicial Affairs.

LAW ENFORCEMENT QUALIFICATIONS AND AUTHORITY

Law enforcement services at Colorado State University-Pueblo are provided by the Pueblo County Sheriff’s Office. The Sheriff’s Office is staffed with experienced State-certified peace officers who are current in Colorado Peace Officer Standards and Training (P.O.S.T.) procedures. Additionally, the Pueblo County Sheriff’s Office provides law enforcement and emergency services to unincorporated Pueblo County, serving a population of 159,063 (2010 Census). This connection to the community means that campus law enforcement is up to date with developments in the community allowing them to better serve the campus. Deputies assigned to Colorado State University-Pueblo actively monitor off campus crime as it relates to the campus, students, faculty and staff. Except for the Pueblo County Sheriff’s Office, no other campus security authority has arrest powers at CSU-Pueblo. The Pueblo County Sheriff’s Office collaborates with the Pueblo City Police Department and the Colorado State Patrol to address security concerns, engage in consultation, and to provide educational programs for employees and students.

REPORTING A CRIME

In the event of any crime or emergency on campus, the Pueblo County Sheriff's Office should be immediately notified as follows:

911 FOR EMERGENCY ASSISTANCE

(719) 583-6250 TO REPORT A CRIME OR SUSPICIOUS ACTIVITY

**PUEBLO COUNTY SHERIFF'S OFFICE AT CSU-PUEBLO
LOWER LEVEL OF THE ADMINISTRATION BUILDING, ROOM 118
(719) 549-2373**

**UNIVERSITY EMERGENCY CALL BOXES – CONNECTS TO SHERIFF'S OFFICE DISPATCH
(MAP ON PAGE 2 SHOWS EMERGENCY CALL BOXES DENOTED BY ORANGE CIRCLES)**

CONFIDENTIAL REPORTING

A witness of a crime who wishes to remain anonymous may call the CSU-Pueblo Tip Line at (719) 549-2376. The Tip Line is a voice message system only; and therefore, immediate action will not be taken. Witnesses of crimes may also report to Pueblo Crime Stoppers at (719) 542-7867.

REPORTING TO A CAMPUS SECURITY AUTHORITY (CSA)

The University encourages students to report criminal activity directly to the CSU-Pueblo Sheriff's Office. However, students may also report a crime to a Campus Security Authority (CSA), who has responsibility for campus security, who have responsibility for student and campus activities and/or who have significant contact with students. Campus Security Authorities are responsible for forwarding non-identifying information to the CSU-Pueblo Sheriff's Office for inclusion in the annual Security report, regardless of whether or not the victim chooses to file a report with law enforcement. The CSA will inform you that you will be required to file a report and/or meet with the CSU-Pueblo Sheriff's Office to begin a formal investigation process.

Who is a Campus Security Authority?

- CSU-Pueblo Sheriff's Office
- Non-police security staff who monitor or control entrance to property
- Residence Hall Desk Staff
- Parking Staff
- Building security staff
- Persons or offices designated under CSU-Pueblo policy as those to whom/which crimes should be reported
- Residence Life Professional and Resident Assistant Staff
- Dean of Student Affairs & Staff
- Associate Dean of Student Affairs & Staff
- Officials with Significant responsibility for student and campus activities

- Coaches
- Greek Life advisors
- Student activities coordinators
- Faculty advisors to student organizations

Who is Exempt from Reporting Under the Clery Act

- Licensed professional mental health counselors
- Pastoral counselors (employed by religious organizations to provide confidential counseling) who are working within the scope of their license or religious assignment at the time they receive the crime report.

SECURITY & ACCESS TO CAMPUS FACILITIES

Preserving a safe and secure environment is the responsibility of everyone on campus. Employees have the responsibility to secure their work area, and students have the responsibility to lock their residence hall rooms and secure their personal property.

Most campus buildings and facilities are accessible to the public during normal business hours Monday through Friday excluding holidays. Certain facilities may be open for designated hours on weekends. Exterior doors on campus buildings are secured each evening by facilities personnel. Buildings may be secured at different times based upon class schedule, special events, and computer lab hours.

SECURITY & ACCESS TO CAMPUS RESIDENTIAL FACILITIES

All residence halls are secured using a card access system. Residence halls are accessible to the campus community and visitors from 8:00 a.m. to 5:00 p.m. Monday through Friday. Residence Halls have restricted access on weekends from 5:00 p.m. on Friday to 8:00 a.m. on Monday. During those hours any visitors must be accompanied by a hall resident, and the resident must provide proper identification and access card. Visitors may be asked to sign in at the front desk. Access to the residence halls after business hours may be made available for campus programming.

Students, faculty, and staff should take the following precautions to prevent circumventing policies designed to protect the safety of self and others:

- Do not prop doors open or allow strangers into campus buildings that have been secured.
- Do not lend keys or leave them unattended.
- Notify the Sheriff's Department of any suspicious activities or individuals.

SECURITY CONSIDERATIONS IN MAINTENANCE OF CAMPUS FACILITIES

Maintenance requests are prioritized at CSU-Pueblo based upon need, budget and emergent conditions. Safety and security issues that are observed may be cause for quicker response and handling. If a student, faculty, staff or visitor notices a potentially dangerous or hazardous condition concerning maintenance, they should immediately contact the University Physical Plant (719) 549-2211.

CRIME PREVENTION

Throughout the year campus personnel and Sheriff's Deputies participate in programs aimed at crime prevention and the community policing philosophy and provide information as it pertains to crime prevention, alcohol use, and illegal drugs. Educational programs are provided to students, faculty and staff that include New Student Orientation and Parent Orientation Safety sessions, Alcohol and Drug Awareness, Active Shooter Awareness, Student Athlete Safety Training, Orientation, Residence Life and Housing Safety Training, DUI Awareness Training

Colorado State University-Pueblo offers the following crime prevention services to improve the safety and security of the campus community:

CAMPUS SERVICE OFFICERS (CSO's): CSU-Pueblo student employees who provide additional foot patrol, building security, parking enforcement, and safe walks by dialing (719) 549-2373 or by utilizing any of the eleven emergency call stations.

CAMPUS SAFE WALK: The Campus Safe Walk program is available to any campus member wishing to have the added security of being escorted from one location to another. Call the CSU-Pueblo Pueblo County Sheriff's Office at (719) 549-2373.

RESIDENCE HALL AND BUILDING PATROL: Patrols include Sheriff's Deputies and CSO's patrolling in and around campus buildings.

EMERGENCY CALL BOXES: Call boxes are found in 11 locations around campus. They can be located by looking for orange boxes with blue lights on campus light poles.

LIGHTING SURVEY: Outdoor lighting is surveyed regularly by facilities personnel and any concerns are addressed. Please call (719) 549-2211 to report lighting issues.

OPERATION ID: Operation Identification allows students to register valuable items with the Pueblo County Sheriff's Office at Colorado State University-Pueblo. The Sheriff's Office will keep the record on file to be used for identification purposes should the items be stolen. The program is open to all students, staff and faculty. Items can be registered by obtaining a form from the Campus Sheriff's Office or online at

<http://www.colostate-pueblo.edu/CampusSafety/sheriffsoffice/Pages/ValuablePropertyRecord.aspx>

INDIVIDUAL SAFETY CONSULTATION: Campus members are encouraged to contact a Deputy with any safety or security concerns by visiting the Pueblo County Sheriff at CSU-Pueblo on the ground floor of the Administration Building, or dialing (719) 549-2373.

EMERGENCY TEXT MESSAGING SYSTEM: Colorado State University – Pueblo's new "CSU-Pueblo ALERT" emergency notification and warning system is an emergency cellular phone text messaging alert service that is available to all students, faculty, and staff who register. In the event of an emergency or unexpected closing of the university, a text message will be sent to all enrolled cell phones. Information about the system may be found at

<http://www.colostate-pueblo.edu/CampusSafety/CSU-PuebloALERT/Pages/default.aspx>

SEXUAL ASSAULT AND SEXUAL HARASSMENT

Colorado State University – Pueblo has zero tolerance for sexual misconduct. All members of the University community, and their guests, have the right to be free from unwanted sexual contact, coercion, abuse, violence, threats of violence, and harassment. Students are expected to conduct themselves in a manner that does not infringe upon the rights of others.

When an allegation of sexual misconduct is brought forward, the University has a duty to investigate the matter and take appropriate action. Anyone found to have committed sexual misconduct will face immediate and appropriate disciplinary action, up to and including expulsion from the University.

This *CSU- Pueblo Sexual Misconduct Policy* affirms these principles and provides recourse and rights for those individuals whose rights have been violated. The policy may be accessed at the following CSU-Pueblo web site page:

<http://www.colostate-pueblo.edu/StudentLife/StudentJudicialAffairs/Pages/SexualMisconductPolicy.aspx>

Sexual misconduct includes any behavior of a sexual nature that infringes upon the rights of any individual to pursue their educational goals in an environment free from violence, intimidation, and/or harassment. This includes but is not limited to, sexual assault, rape, other forms of non-consensual sexual contact, sexual harassment, and sexual exploitation.

SEXUAL ASSAULT - Definitions of Sexual Assault may be found in the CSU-Pueblo Sexual Misconduct Policy

If a Student Has Been Sexually Assaulted, the student should take steps to assure s/he is safe and should then seek any medical assistance if necessary. Parkview Medical Center in Pueblo, Colorado provides Sexual Assault Nurse Examiners (SANE) who can conduct the appropriate and necessary examination to preserve evidence and provide medical assistance. The Pueblo Rape Crisis Center (719) 549-0549 will provide an advocate to accompany the student to the hospital and will also inform the student of additional resources. The Rape Crisis Center operates a 24-hour hotline for services.

The student should also report the incident to the appropriate law enforcement authorities that include CSU-Pueblo Campus Sheriff's Office (719) 583-6250 if the assault occurred on campus or to the Pueblo Police Department (719) 553-2538 if the assault occurred off-campus.

The University has designated the Associate Dean of Student Affairs as the CSU-Pueblo Sexual Assault Response Coordinator to respond to students who have been sexually assaulted or experienced sexual exploitation. The student is strongly encouraged to report the incident to the Coordinator and to seek her services at any time. She will 1) take steps to ensure a safe environment for the student; 2) provide support, information and guidance; 3) provide information regarding community and campus resources; 4) coordinate services available to the victim; and 5) serve as an ongoing point of contact for the student. The Coordinator will also work with the student to make any necessary housing arrangement changes, adjustments to class schedules, contacting professors, and any other issues that may arise for the student. If a student is uncomfortable talking with law enforcement, the Coordinator will assist with notifying the authorities if the student requests the services.

Ms. Marjorie Villani, Associate Dean of Student Affairs
Sexual Assault Response Coordinator (SARC), Title IX Co-Coordinator
Office Located in OUC 003 (Lower Level) Direct Office Line (719) 549-2223

SEXUAL HARASSMENT: Definitions of Sexual Harassment may be found in the CSU-Pueblo Sexual Misconduct Policy

Students, faculty, or staff who have been sexually harassed; are encouraged to file the report as soon as possible with the Affirmative Action and EEO Director. She will receive the report and will implement a review and/or investigation of the incident/allegation. Employee allegations related to sexual harassment fall under the CSU-Pueblo employee policies and procedures. Student allegations fall under the *CSU-Pueblo Sexual Misconduct Policy*.

Ms. LaNeeca Williams, Director of Affirmative Action and EEO & Title IX Co-Coordinator
Office Located in OUC 031 (Lower Level) Direct Office Line (719) 549-2210

SEXUAL ASSAULT AND SEXUAL HARASSMENT EDUCATIONAL PROGRAMS: Colorado State University – Pueblo provides sexual assault awareness training and educational programs to students, faculty, and staff. Freshman students are required to attend orientation where a sexual assault and date rape awareness program is presented to all students. Additionally all male athletes and female athletes are required to attend separate training sessions that address sexual assault, date rape, dating safety, and the process for reporting any type of sexual assault, and all coaching staff attend a separate sexual assault awareness program. Separate training is provided to all orientation leaders and resident assistants. All student groups are provided with information on how to report a sexual assault and are introduced to the University Sexual Assault Response Coordinator (SARC) and provided with contact information.

The University has developed a Sexual Assault Awareness information card that is distributed to all students. The card provides students with: 1) the CSU-Pueblo Sexual Assault Policy; 2) who a student should contact if s/he has been sexually assaulted; 3) contact information for the Sexual Assault Response Coordinator; 4) contact information for the reporting to law enforcement; 5) the services and assistance that will be provided to students who report a sexual assault; 6) on-campus health counseling services; and 7) off-campus rape-crisis services.

Additionally, posters are placed on campus with specific contact information for on and off-campus services, on and off-campus law enforcement agencies, and contacts for on and off-campus medical and counseling services. The University also presents special programs in the residence halls and educational programs and information tables throughout the year in various campus locations.

The Director of Affirmative Action and Equal Employment Opportunity provides sexual harassment training programs on a regular basis to students, faculty, and staff. She also provides specific training for Resident Assistants, Coaches, and orientation leaders. Posters and publications are distributed campus-wide.

CAMPUS DISCIPLINARY ACTION FOR SEXUAL MISCONDUCT: The Code of Student Conduct and Adjudication provides procedures for campus discipline. Both the alleged victim and accused are entitled to the same opportunities to have others present during a disciplinary hearing. Both the alleged victim and the accused are informed of the outcome of any disciplinary actions and sanctions, particularly those incidents that involve sexual misconduct. If the alleged victim is deceased, the next of kin of such victim shall be treated as the alleged victim for purposes of this disclosure

Students accused of sexual misconduct are entitled to the hearing process set forth in the Code of Student Conduct and Adjudication in order to determine whether they violated University policies, and if so, what sanctions should be imposed. However, the University reserves the right to take whatever measures it deems necessary in response to an allegation of sexual misconduct in order to protect students' rights and personal safety. Such measures include, but are not limited to, modification of living arrangements, interim suspension from campus pending a hearing, and/or reporting to appropriate law enforcement.

A student alleged to have engaged in sexual misconduct can be disciplined under the Code of Student Conduct and Adjudication and/or prosecuted under Colorado statutes. Not all forms of sexual misconduct will be deemed to be equally serious offenses, and the University may impose differing sanctions, up to and including expulsion, depending upon the nature of the offense. The Code of Student Conduct and Adjudication may be accessed at:

<http://www.colostate-pueblo.edu/StudentLife/StudentJudicialAffairs/StudentConductCode/Pages/default.aspx>

SEX OFFENDER REGISTRY

Registered sex offenders must provide notice when they are employed at, volunteer at, or are enrolled at Colorado State University-Pueblo. Information about sex offenders enrolled at Colorado State University-Pueblo may be obtained from the Pueblo County Sheriff's Office at CSU-Pueblo in the basement of the administration building (719) 549-2373. Additionally information is available at the Pueblo County Sheriff's Office: <http://www.sheriff.co.pueblo.co.us/>

ALCOHOL AND DRUG POLICY

CSU-Pueblo is committed to fostering and sustaining an environment that furthers academic and student development. Within this context, the health and safety of our students is paramount. The University recognizes the dangers and effects that alcohol and other drugs have on the success of students, and will not tolerate the excessive, inappropriate and/or illegal use and/or abuse of alcohol or illegal drugs. The University complies with all local, state, and federal laws concerning alcohol and illegal drugs. CSU-Pueblo students are responsible for acquainting themselves with these laws and the University's policies regarding alcohol and other drugs.

The University provides alcohol and drug awareness programs in residence halls and to the larger student population. These educational programs address safe alcohol consumption, driving and alcohol consumption awareness, safe dating and alcohol consumption, and other programs that address specific needs of student groups.

Alcohol sale is permitted at selected sites for special events on campus for those students who meet or exceed the legal age of 21. Alcohol is not permitted in any of the residence halls. Alcohol is permitted in the Walking Stick Apartments and can be consumed only by those residents who are (21) years of age and older.

This CSU-Pueblo Drug and Alcohol Policy applies to all students at Colorado State University-Pueblo. While these regulations apply primarily to acts of misconduct occurring on University premises, the University may adjudicate violations of standards occurring off campus and that have, or may threaten to have, a significant impact on the University's mission or activities, or on the health, safety, or security of the University and members of the University community. The decision whether to adjudicate a specific off-campus incident shall be made at the sole discretion of the Director of Student Judicial Affairs.

Alcohol and other drugs will not be allowed to interfere with classroom learning, residence hall living, co-curricular activities, or any other CSU-Pueblo related or sponsored event. The following regulations serve to protect, sustain, and further the academic and personal standards that collectively form and affirm the meaningful learning environment:

- a. All CSU-Pueblo students are required to abide by University policies, as well as local, state and federal regulations regarding alcohol and other drugs.
- b. The use, possession, manufacturing, consumption, distribution, or presence of alcohol is prohibited at all times in all University Housing (whether on- campus or off-campus).
- c. Residents of the University Village at Walking Stick apartments and their authorized guests who are of legal drinking age are permitted to possess and consume alcohol inside their private apartments, provided that the legal consumption of alcohol does not hinder the educational mission of the institution, hinder students in their ability to pursue their educational endeavors, or violate relevant University policies.
- d. The possession or use of "beer bong" or other devices that dispense alcohol is prohibited.

- e. The promotion, possession or playing of alcoholic drinking games (e.g. beer pong) is prohibited.
- f. All student organization functions or student sponsored functions are required to be alcohol- free. Exemptions may be granted by the Dean of Student Affairs in accordance with section VI of this policy.
- g. University sponsored functions are exempt from this policy, provided that sponsors take adequate precautions to ensure responsible and legal use of alcohol.
- h. The possession, use and/or distribution of illegal drugs is strictly prohibited.
- i. The possession, use and/or distribution of prescription drugs or other controlled substances, except under the direction of a licensed physician, is prohibited.

The above policies are applicable to any and all students regardless of their age. Alcohol and drug related offenses may be charged under Colorado State Statute, and/or student conduct violations. The Alcohol and Other Drug Policy is Available at:

<http://www.colostate-pueblo.edu/StudentLife/StudentJudicialAffairs/AlcoholAndOtherDrugPolicy/Pages/AlcoholAndOtherDrugPolicy.aspx>

MISSING STUDENT POLICY

Colorado State University-Pueblo takes student safety very seriously. The following policy has been established to assist in locating CSU-Pueblo students living in CSU-Pueblo owned or leased housing who, based on the facts and circumstances known to CSU-Pueblo, has been determined missing for at least 24 hours. This policy outlines the notification procedures of Colorado State University-Pueblo for missing students who reside on-campus and complies with the requirements of Section 485 of the Higher Education Opportunity Act of 2008.

CONFIDENTIAL CONTACT: Every student who resides in on-campus housing shall have the option to identify a confidential individual to be contacted by the University in the event that the student is determined missing. Upon initial check-in at the on-campus housing facility, students will be given the option to identify a contact person who the Office of Residence Life and Housing, Dean of Student Affairs or the Pueblo County Sheriff's Office at CSU-Pueblo shall notify if the student is determined missing no more than 24 hours after the time the student is determined missing. This additional contact information will be confidential, accessible only to authorized campus officials and law enforcement, and may not be disclosed outside of a missing person investigation.

PROCEDURE: All concerns of a possible missing person should be immediately reported to the Pueblo County Sheriff's Office at CSU-Pueblo at (719) 549-2373.

Upon receiving information that a student cannot be located and may be missing, the Pueblo County Sheriff's Office at CSU-Pueblo will notify the Office of Residence Life and Housing and the Dean of Student Affairs (or a designee) of the missing person concern and attempt to gather information about the student. After consultation with the Office of Residence Life and Housing and Pueblo County Sheriff's Office at CSU-Pueblo, the Pueblo County Sheriff's Office will submit a missing person report and initiate an investigation that may include the following:

- Conduct a welfare check into the student's room
- Contact known contacts (roommates, friends, faculty members, employers, etc.)
- Obtain class schedule and search classrooms and campus public locations (library, university center, etc.)
- Access card access logs to determine last use of the card and track the card for future uses

- Access vehicle registration information for vehicle location and search campus parking lots
- Look up email logs for last login and use of CSU-Pueblo email system

If the student cannot be located after reasonable efforts, the Office of Residence Life and Housing, the Dean of Student Affairs, or Pueblo County Sheriff's Office at CSU-Pueblo will call the student's contact person no later than 24 hours after the student is determined to be missing. If the missing student is under the age of 18 and is not an emancipated individual, the Office of Residence Life and Housing, the Dean of Student Affairs, or Pueblo County Sheriff's Office will also notify the custodial parent or legal guardian no later than 24 hours after the student is determined to be missing.

ENVIRONMENTAL HEALTH AND SAFETY PROGRAM

THE ENVIRONMENTAL HEALTH AND SAFETY (EH&S) DEPARTMENT AT COLORADO STATE UNIVERSITY-PUEBLO is charged with the responsibility of promoting a safe environment for students, faculty, staff, and visitors. This includes fire safety programs, hazardous materials programs, safety hazard mitigation, and emergency preparedness.

FIRE DEPARTMENT QUALIFICATIONS: Fire protection for the Colorado State University-Pueblo campus is provided by the Pueblo City Fire Department. The University is within the one minute response band from the first in Engine Company (8) stationed at 1551 Bonforte Blvd approximately 1.14 miles from the University. Engine Company 8 consists of a 2011 Sutphen pumper; capable of pumping 1250 gpm that is staffed 24 hours a day seven days a week with one captain, one engineer, and one emergency medical officer. Additional resources are available from any of nine other stations located throughout the city. Each station is staffed 24/7 and consist of at least one engine company. Advanced resources including a staffed heavy rescue unit, a staffed ladder truck and hazmat resources are available from station 1 located at 425 W 7th Street, approximately 3.89 miles from the University. If Engine Company 8 is out on another call, another Engine company will respond to campus. Additionally American Medical Response has an ALS ambulance stationed at the corner of Jerry Murphy Road and Bonforte Blvd, approximately 1.2 miles from the University.

Pueblo City Fire was the fourth out of 400 fire departments in Colorado, and one of 127 in the nation, to achieve Distinguished Accreditation Status from the Center for Public Safety Excellence. All Pueblo City Firefighters carry a minimum of an EMT-Basic and Firefighter 1. Additionally at least one member of each engine company is certified as an EMT-Paramedic. More information on the Pueblo Fire Department may be accessed at <http://www.pueblo.us/index.aspx?NID=235>

FIRE SAFETY POLICIES

FIRE ALARM PROCEDURES: When an alarm sounds, students should immediately begin to evacuate the building and take the following measures:

1. Leave the room immediately.
2. Close the room door and lock it.
3. Walk quietly and quickly to the nearest exit. Do not use the elevators.
4. Remain outside until the signal is given to return to their room.

Students are required to obey all fire regulations. Failure to evacuate a hall when an alarm sounds represents grounds for disciplinary action. Residence Hall staff, CSU-Pueblo Sheriff's staff, Director of Environmental Health and Safety, and the Pueblo Fire Department reserve the right to enter student rooms to locate the source of any potential fire or smoke hazard and to ensure that everyone has evacuated the building.

ELECTRICAL APPLIANCES: To help ensure a safe living environment, the following appliances are permitted: microwave ovens (less than 700 watts), refrigerators (no more than 4 cubic feet), coffee pots, air popcorn poppers, pop-up toasters, hair dryers, electric shavers, radios, TVs, stereos and irons. Microwave ovens are the only cooking appliances permitted for use in student rooms. No homemade electrical appliance will be permitted. You must provide an UL-approved power strip with a self-contained circuit breaker if you plan to operate appliances in your room. Octopus plugs are not permitted.

Additionally, residents must be present when using any cooking appliance or iron in student rooms or in hall kitchens.

Those items which are NOT allowed include but are not limited to: electric heaters, oil popcorn poppers, hotplates, toaster ovens, "George Foreman" or similar type grills, open coiled or open flame appliances, deep fryers, convection ovens and any appliances with an open heating element and torchier lamps and neon lights. Also, only those halogen lights with guards will be permitted.

EMERGENCY PROCEDURES: For any emergency call 911 or (719) 583-6250

Fire and Safety Equipment: Tampering with fire and safety equipment in the residence hall or in any campus building is prohibited. Tampering includes pulling false fire alarms, discharging fire extinguishers, removing exit signs, and interfering with smoke detectors. Interference with smoke detectors will result in disciplinary action. Students responsible will be assessed for all damages that occur as a result of their tampering with fire and/or safety equipment. In addition, all violators are subject to judicial action and possible criminal prosecution.

FLAMMABLE LIQUIDS: Gasoline, kerosene, ether, oil and any other flammable liquids are prohibited in residence hall.

CANDLES/INCENSE/OPEN FLAMES OR HEAT SOURCES: Candles used with a candle warmer are allowed in the residence hall. Any candles with wicks that have been burned will be confiscated. Incense and any item with an open flame or exposed heat source are potential fire hazards and are prohibited.

SMOKING/USE OF TOBACCO PRODUCTS: The use of tobacco products and smoking is prohibited in the residence hall. The use of tobacco products is prohibited within twenty five (25) feet of any such building intake duct, window or entrance or entryway, including ramps, walkways, pathways, and any such similar means of entry, unless a University designated tobacco use shelter is otherwise provided. Tobacco products must be used in the designated areas.

Persons who wish to use tobacco products outside of the residence hall shall do so in a manner that minimizes an accumulation of smoke and tobacco waste. Individuals who use tobacco products are responsible for the proper disposal of such in designated receptacles.

FIRE SAFETY TRAINING FOR STUDENTS, FACULTY, & STAFF: Residence hall students are informed of evacuation procedures at the beginning of the academic year at floor meetings. Fire drills involving evacuation are held every semester in the residence halls and student staff members are trained on evacuation procedures and fire extinguisher use when hired as a Resident Advisor.

EVACUATION PROCEDURES ARE PROVIDED ONLINE AT:
<http://www.colostate-pueblo.edu/EHS/FireSafety/Pages/default.aspx>

FIRE EXTINGUISHER PROCEDURES ARE PUBLISHED ONLINE AT:
<http://www.colostate-pueblo.edu/EHS/FireSafety/UsingFireExtinguishers/Pages/default.aspx>

PLANS FOR FUTURE IMPROVEMENTS

Improvements, upgrades, and repairs to fire safety systems are made when tests and or evaluations indicate a problem exists.

FIRE STATISTICS

Building	Fires			Fire-related Fatalities			Fire-related Injuries			Value of Property Damages		
	Year	2009	2010	2011	2009	2010	2011	2009	2010	2011	2009	2010
Belmont Hall	1	0		0	0		0	0		0	0	
Culebra Hall	n/a*	0		n/a	0		n/a	0		n/a	0	
Crestone Hall	0	0		0	0		0	0		0	0	
Greenhorn Hall	n/a*	0		n/a	0		n/a	0		n/a	0	

*Culebra and Greenhorn Halls opened August 2010

FIRE SUPPRESSION AND DETECTION SYSTEMS

A fire alarm system is available in each on-campus student housing facility that includes Belmont, Crestone, Culebra, and GreenHorn Halls. Each building and their corresponding fire alarm system contains a Siemens' main control panel and initiating and notification devices. Examples of initiating devices are: smoke detectors, heat detectors, pull stations, and fire sprinkler control valves. Examples of notification devices are: horns, strobes, and speakers. In addition to monitoring the status of these devices, it also monitors the status of field wiring, annunciators, back-up batteries, and internal operations. When a condition occurs from any one of these devices or a problem is detected within the control panel itself, the main control panel transmits a signal—alarm, trouble, or supervisory—to a Digital Alarm Communicator Transmitter located at the Heating Plant.

The method to transmit this information is via the campus' fiber optic loop. Fiber optic transceivers are utilized to interface the main control panels between each building and with the Digital Alarm Communicator Transmitter located at the Heating Plant. The DACT is the end point for communication from all fire alarm systems located on campus. The DACT's primary responsibility is to report the signals from all building fire alarm systems to the Siemens monitoring center via analog telephone lines. The monitoring center acts according to the type of signals received. Upon receipt of a fire alarm signal, they first notify the downtown sheriff's department, who in turn, dispatches the nearest fire department and also notifies Environmental Health and Safety and Pueblo County Sheriff at CSU-Pueblo. Upon receipt of trouble and supervisory signals, CSU-Pueblo personnel are notified so that these conditions can be repaired.

In addition, all of CSU-Pueblo's fire alarm systems serve the purpose of voice evacuation. Each individual building has the ability to initiate building-wide voice commands from their control panel. Global (campus wide) voice commands can be initiated from one of two designated buildings—the campus Sheriff's Department and the Physical Plant building. The control panel located in the Sheriff's Department serves

as the master page panel and the control panel located in the Physical Plant Building serves as a slave panel to the master page panel. Both have the ability to initiate campus wide voice commands in the event of an emergency.

While not interconnected to the fire alarm system, it should be noted that smoke alarms are located in individual's living quarters in Belmont, Crestone, Culebra, and GreenHorn Halls. Belmont Hall utilizes battery-powered smoke alarms while Crestone, Culebra, and GreenHorn Halls utilizes 120VAC hardwired units with battery back-up. As noted above, these are used only for local evacuation purposes within the room and are not connected to the building fire alarm system.

Table 7: Fire Suppression and Detection Systems							
Building	Fire Alarm	Room Detection	Room Detection Reporting	Central Station Reporting	Automatic Sprinkler System	Stand Pipes	Fire Drills Conducted
Belmont Hall	Yes	Yes	No	Yes	Partial	Yes	2
Culebra Hall*	Yes	Yes	No	Yes	Yes	Yes	2
Crestone Hall	Yes	Yes	No	Yes	Yes	Yes	2
Greenhorn Hall*	Yes	Yes	No	Yes	Yes	Yes	2

*Culebra and Greenhorn Halls opened August 2010

EMERGENCY PREPAREDNESS

Colorado State University-Pueblo is actively involved in the emergency preparedness and planning process. CSU-Pueblo has developed an overall guiding document entitled the Campus Emergency Plan. This plan lays out the overall framework of preparedness and response for the university. To review the Campus Emergency Plan contact Environmental Health and Safety at (719)549-2747.

TIMELY WARNINGS

Under the *Clerly Act* (20 U.S.C. state § 1092) and its implementing regulations, Colorado State University-Pueblo, through designated personnel, is responsible for issuing a “timely warning” if a crime has been reported and CSU determines there is a serious or continuing threat to the campus community. In addition, CSU-Pueblo is required to send an “emergency notification” if there is an immediate threat to the health or safety of students or employees occurring on campus.

The decision to issue a “timely warning” or an “emergency notification” will be decided on a case-by-case basis in compliance with the *Clerly Act* and after consideration of available fact. The issuance of a timely warning may depend on the nature of the crime, the continuing danger to the campus community, and possible risk of compromising law enforcement efforts. Similarly, the issuance of an emergency notification depends upon the particular health or safety threat. CSU will, without delay, take into account the safety of the community, determine the content of the notification and initiate the emergency notification system.

EMERGENCY NOTIFICATION SYSTEM

The University is committed to ensuring the campus community receives timely, accurate, and useful information in the event of an emergency situation on campus or in the local area that poses a risk to the health and safety of campus community members. To support this commitment, the University has invested in several multi-modal forms of communications that allow administrators to quickly distribute notices of a critical incident or dangerous situation. Some or all of these methods of communication may be activated in the event for emergency notification to all or a segment of campus community. These methods of communication include the mass notification system (*CSU-P ALERT*), the University’s email system, campus PA system, and/or emergency messages that scroll across computer screens. The University will post updates during a critical incident on the CSU-Pueblo homepage. If the situation warrants, the University will establish a telephone call-in center staffed by University specialists who are trained to communicate with the campus community during an emergency situation.

CONFIRMING THE EXISTENCE OF A SIGNIFICANT EMERGENCY OR DANGEROUS SITUATION AND INITIATING THE EMERGENCY NOTIFICATION SYSTEM: The notification system will be immediately activated when University-authorized representatives - including supervisors in the Pueblo County Sheriff’s Office, individuals assigned to Environmental Health and Safety, and/or other members of the University’s senior administration - become aware of and confirm a critical incident or other emergency situation that potentially affects the health and/or safety of the campus community

DETERMINING THE APPROPRIATE SEGMENT OR SEGMENTS OF THE CAMPUS COMMUNITY TO RECEIVE AN EMERGENCY NOTIFICATION: Law enforcement and university officials on the scene of a critical incident or dangerous situation that poses an immediate threat to the health or safety of the campus community will assist those preparing the emergency notification with determining what segment or segments of the campus community should receive the notification. Generally, campus community members in the

immediate area of the dangerous situation (i.e. the building, adjacent buildings, or surrounding area) will receive the emergency notification first. The University may issue subsequent notifications to a wider group of community members. In addition to the emergency notification that may be issued via the University mass notification system, the University will also post applicable messages about the dangerous condition on the University homepage to ensure the rest of the campus is aware of the situation and the steps they should take to maintain personal and campus safety. If the emergency affects a significant portion of or the entire campus, University officials will distribute the notification to the entire campus community.

DETERMINING THE CONTENTS OF THE EMERGENCY NOTIFICATION: With the assistance of the Pueblo County Sheriff's Office, the University will determine the content of the notification. The University has developed a wide range of template messages addressing several different emergency situations. The communications officers (or others issuing the alert) will select the template message most appropriate to the on-going situation and modify it to address the specifics of the present incident. Those issuing the notification will use the following guidelines when determining the contents of the emergency message.

The first message is intended to Alert the community or appropriate segment of the campus community of the dangerous condition and the actions they should take to safeguard their and their neighbors safety. Messages distributed in this stage of a rapidly unfolding critical incident will generally be short, precise, and directive. Examples include: "The campus is experiencing a major power outage affecting the following buildings: Belmont, Crestone, Culebra, and Greenhorn Halls. All occupants of these buildings should immediately evacuate and meet at the designated building rally point." "There is a chemical spill at Culebra Hall. The chemical released is extremely hazardous if inhaled. Occupants of Culebra Hall should immediately evacuate the building through the northeast exits. Follow the directions of fire personnel who are on scene."

The second message is intended to inform the community or appropriate segment of the campus community about additional details of the situation. This message is generally distributed once first responders and the Emergency Operations Center has additional information about the dangerous situation. Examples include: "The power outage affecting Belmont, Crestone, Culebra, and Greenhorn Halls was caused by a cut power line. Technicians are responding along with Facilities personnel to repair the damage. We expect the outage will last until 2:00 p.m. Refer to the University homepage for additional information or dial 719-583-6250.

Finally, the third message is the Reassure notice that is generally distributed once the situation is nearly or completely resolved. The purpose of this message is to reassure the community that the University is working diligently to resolve the dangerous situation. It can also be used to provide additional information about the situation and where resources will be available.

In those cases where there are no pre-determined template messages in the system, the individual issuing the alert will develop the most succinct message to convey the appropriate message to the community. The goal is to ensure individuals are aware of the situation and that they know the steps to take to safeguard their personal and community safety.

COLORADO STATE UNIVERSITY – PUEBLO CRIME STATISTICS

The University campus crime statistics includes three general categories of crime statistics as required by the *Clery Act*.

CATEGORIES OF CRIME STATISTICS AS REQUIRED BY *CLERY ACT*

1. TYPES OF OFFENSE:

- | | |
|--------------------------------------|--|
| a. Murder and non-negligent homicide | h. Motor Vehicle Theft |
| b. Negligent manslaughter | i. Arson |
| c. Forcible Sex Offenses | j. Hate Crimes (Disclose whether any of the above-mentioned offenses, or any other crimes involving bodily injury were hate crimes.) |
| d. Non-forcible Sex Offenses | |
| e. Robbery | |
| f. Aggravated Assault | |
| g. Burglary | |

2. HATE CRIMES – REPORTED BY CATEGORY OF PREJUDICE.

- | | |
|-------------------|--|
| a. Theft | d. Criminal Mischief / Property damage |
| b. Simple Assault | e. Any other crime involving bodily injury |
| c. Intimidation | |

Hate crime categories reported category of prejudice to include race, gender, religion, sexual orientation, ethnicity, and disability.

During the 2010 reporting period, CSU-Pueblo had one Hate Crime with a prejudice of sexual orientation.

3. ARRESTS OR REFERRALS FOR DISCIPLINARY ACTION - For illegal weapons possession and violation of drugs and liquor laws.

DEFINITIONS OF STATISTICS

ON-CAMPUS CRIME STATISTICS: On-campus crime statistics reflect crimes committed anywhere on the Colorado State University-Pueblo campus. This includes the residence halls and Walking Stick Apartments.

• RESIDENCE HALL CRIME STATISTICS

The residence hall data is a subset of the on-campus data. This data represents only reportable criminal activity that occurred in the residence halls, including Walking Sticks Apartments. It is important to note that in 2007 and 2008 there was only one location for on-campus housing (Belmont Residence Hall). In August of 2009 Crestone residence hall was completed, and Greenhorn and Culebra Halls were opened in the fall of 2010.

• NON-CAMPUS BUILDING CRIME STATISTICS

The data presented below represents crime in non-campus buildings that are being used by the University. It is important to note that the University utilized non-campus housing from August 2008-May 2009 only.

PUBLIC PROPERTY CRIME STATISTICS

The data presented below is for reportable crimes that occurred on public property. Public property as defined by the *Clery Act* is all public property that is within the same reasonably contiguous geographic area of the institution to include public streets and sidewalks.

CRIME STATISTICS TABLE CSU-PUEBLO

CLERY Crime Report	CSU-Pueblo On Campus (NOT Residence Halls)			CSU-Pueblo Residence Halls (On-Campus)			Non-Campus			Public Property			Wolf Village		
	2008	2009	2010	2008	2009	2010	2008	2009	2010	2008	2009	2010			2010
Criminal Homicide															
Murder and Non-Negligent Manslaughter	0	0	0	0	0	0	0	0	0	0	0	0			0
Negligent Manslaughter	0	0	0	0	0	0	0	0	0	0	0	0			0
Sex Offenses															
Forcible	0	0	0	0	1	1	1	0	0	0	0	0			0
Non-forcible	0	0	0	0	0	0	0	0	0	0	0	0			0
Robbery	0	0	0	0	0	0	0	1	0	0	0	0			0
Aggravated assault	0	1	0	0	0	1	0	0	0	0	0	0			1
Burglary	6	9	1	17	10	14	2	0	0	0	0	0			5
Motor Vehicle Theft	1	0	1	0	0	0	0	0	0	0	0	0			0
Arson	0	0	1	0	0	0	0	0	0	0	0	0			0
Arrest (Summons)															
Illegal weapons	0	0	0	0	1	0	0	1	0	0	0	0			0
Violations of Drug laws	1	0	2	4	7	21	0	0	0	0	0	0			0
Violation of Liquor laws	3	0	4	27	39	28	4	8	0	0	0	0			8
Referrals for Disciplinary Actions Only															
Illegal weapons	0	0	0	n/a	0	0	0	0	0	0	0	0			0
Drug Violations	7	0	3	n/a	7	32	0	0	0	0	0	0			0
Liquor Violations	25	0	5	n/a	81	83	0	0	0	0	0	0			0
Hate Crimes															
Criminal Mischief/Property damage	0	0	1	0	0	0	0	0	0	0	0	0			0

- Forcible Sex Offenses Include 1) First and Second Degree Sexual Assault-- The carnal knowledge of a person, forcibly and/or against a person's will or where the victim is incapable of giving consent; and 2) Third Degree Sexual assault--The touching of private body parts of another person for the purpose of sexual gratification, forcibly or against that person's will or where the victim is incapable of giving consent.
- Non Forcible Sex Offenses Include Other Non-Forcible Sex Offenses - Incest and Statutory Rape
- Hate Crimes that involve any of the following must be reported: Murder and non-negligent manslaughter; Negligent Manslaughter; Forcible Sex Offenses; Non-Forcible Sex Offenses; Robbery; Aggravated Assault; Burglary; Motor Vehicle Theft; Arson; Larceny/Theft; Simple Assault; Intimidation; Destruction/Damage/Vandalism of Property. The Hate Crime reported in 2010: Sexual Orientation Bias
- The following three types of incidents must be reported if they result in an arrest (summons): 1. Liquor Law Violations; 2. Drug Law Violations; and 3. Illegal Weapons Possession
- Non-Campus Property Includes off-site housing at two local hotels for 2008 & 2009 only.
- Wolf Village: Privately-owned, student-only housing adjacent to campus. Reporting for Wolf Village began January 2010.
- Those values marked "n/a" for 2008 were added as requirements for 2009 and beyond.