

B-D 39.11/1989/108
C.1

D0103 89

STATE OF COLORADO

EXECUTIVE CHAMBERS

136 State Capitol
Denver, Colorado 80203-1792
Phone (303) 866-2471



Roy Romer
Governor

EXECUTIVE ORDER

APPOINTMENT OF A BOARD OF APPRAISERS

WHEREAS, the Colorado Department of Military Affairs owns property in Denver, Colorado (legal descriptions- Exhibit A attached);

WHEREAS, 28-3-106(1)(s) C.R.S. (1982 and 1987 Supp.) provides that if, in the judgment of the adjutant general, any real estate which has been acquired for military purposes is unsuitable for military purposes, the adjutant general, by and with the approval of the Governor, in writing, has authority to sell, trade or otherwise dispose of such real estate, but such real estate shall not be disposed of for less than the appraised value of same, the appraisal to be made by a board of three appraisers to be appointed by the Governor; and

WHEREAS, the Department of Military Affairs has submitted the names of Donald Lareu, Jr., Susan A. King and John S. Butler as a proposed board of appraisers to evaluate the property at issue.

NOW, THEREFORE, I, Roy Romer, Governor of the State of Colorado, under the powers vested in me by C.R.S. 28-3-106(1)(s), do hereby appoint Donald Lareu, Jr., Susan A. King and John S. Butler to serve together as a board to evaluate and appraise the property designated.

GIVEN under my hand and the Executive Seal of the State of Colorado this 15th day of February, 1989.

Roy Romer
Governor



LAND INVENTORY RECORD

Exhibit I
Page 1

ACQUISITIONS

Code No. _____ Colorado National Guard _____ Denver _____
Agency City or Town

Parcel No. _____ Area in Acres 3.85 Name of Property Denver National Guard Function Headquarters
the Adjutant General

Location: Denver Denver Arlington Park
County City or Town Sec. Twp. or Subdiv. Range
Quit Claim

Conveyance: Deed 11-20-37 11-20-37 302747 5280 387
Type Date Recorded Docket No. Bk. No. Pg. No.

Obtained From Highlander Boy Foundation Date of Purchase _____ Cost \$ 10.00 & oc

Appraised
 Value: Land \$ _____ Buildings \$ _____ Total \$ _____

Plat No. _____

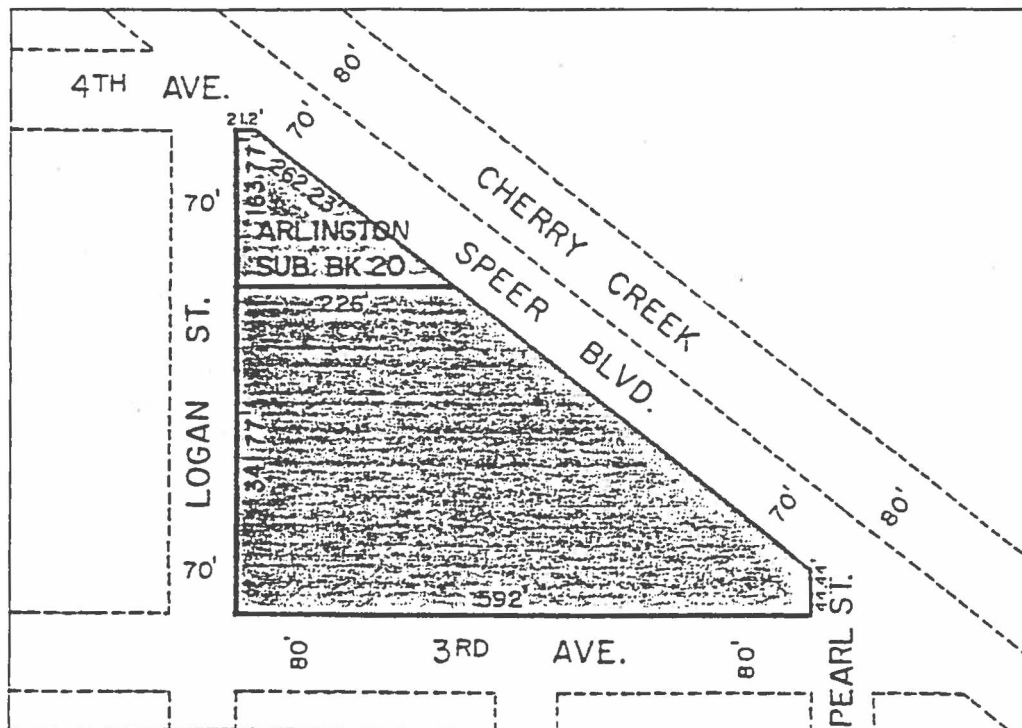

LEGAL DESCRIPTION

Beginning at a point where South line of 4th Avenue intersects the East line of Logan Street, as now laid out and existing; thence South along said East line of Logan Street One Hundred Sixty-three and 77/100ths (163.77) Feet to a point where South line of Block Twenty (20), Arlington Park produced Westerly intersects said East line of Logan Street as now existing; thence East Two Hundred Twenty-six (226) Feet to a point where South line of Block Twenty (20), Arlington Park intersects Southwesterly line of Speer Boulevard

(also known as Forest Drive); thence in a Northwesterly direction along said Southwesterly line of Speer Boulevard Two Hundred Sixty-two and 23/100ths (262.23) Feet, more or less, to a point where South line of 4th Avenue intersects Southwesterly line of said Speer Boulevard; thence West along said South line of 4th Avenue Twenty-one and 2/10ths (21.2) Feet to point of beginning, being that portion of Block Twenty (20), Arlington Park lying West and South of said Speer Boulevard (also known as Forest Drive) and also that portion of Logan Street as shown by Original Plat of Arlington Park which has been vacated and which adjoins said Block Twenty (20) on the West, City and County of Denver and State of Colorado.

That part of the Southeast One-quarter ($SE\frac{1}{4}$) of the Northeast One-quarter ($NE\frac{1}{4}$) of Section Ten (10), Township Four (4) South Range Sixty-eight (68) West, more particularly described as follows: Beginning at a point on the North line of the Southeast One-quarter ($SE\frac{1}{4}$) of the Northeast One-quarter ($NE\frac{1}{4}$) of Section Ten (10), Township Four (4) South Range Sixty-eight (68) west, Eighty-six and 45/100ths (86.45) Feet East of Northwest corner of said Southeast One-quarter ($SE\frac{1}{4}$) of the Northeast one-quarter ($NE\frac{1}{4}$) of said Section Ten (10), where East line of Logan Street intersects said North line of said Southeast One-quarter ($SE\frac{1}{4}$) of the Northeast One-quarter ($NE\frac{1}{4}$) of Section Ten (10); thence South along East line of Logan Street three hundred forty-one and 77/100th (341.77) feet, more or less, to North line of 3rd Avenue; thence East along said North line of 3rd Avenue Five Hundred Ninety-two (592) Feet, more or less, to West line of Pearl Street; thence North Forty-four and 44/100ths (44.44) Feet, more or less, to Southwesterly line of Speer Boulevard; thence Northwesterly along said Southwesterly line of Speer Boulevard to the North line of said Southeast One-quarter ($SE\frac{1}{4}$) of the Northeast One-quarter ($NE\frac{1}{4}$) of said Section Ten (10); thence West along said North line Two Hundred and Twenty-six (226) Feet, more or less, to the place of beginning, City and County of Denver and State of Colorado.